



# Submittal Data Information

## U Tube Heat Exchangers

201-008

6" DIAMETER STEAM

EFFECTIVE: APRIL 15, 1995

Job: \_\_\_\_\_

Item No.	Model No.	Pass	GPM Tubes	Temp. In	Temp. Out	Steam Pressure Shell	Pressure Drop Tubes	Velocity Tubes

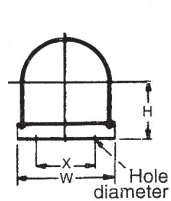

**SADDLES**  
(Optional)

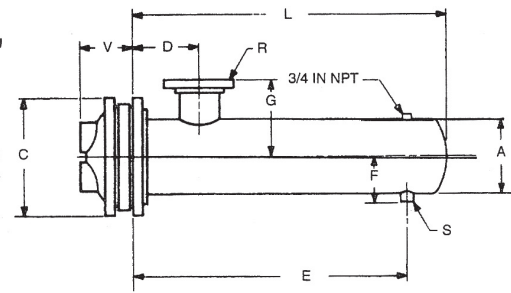
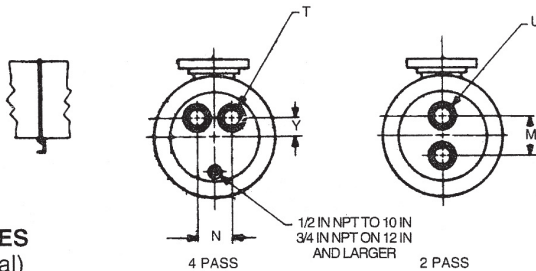

**DIMENSIONS**

6 Inch Diameter

Model Number		Cast Iron Heads						Dimensions (inches)										Heating Surface (sq. ft.)	Shipping Weight (lbs.)
2 Pass	4 Pass	2 Pass		4 Pass				2 and 4 Pass											
		M	U	N	T	Y	V	A	C	D	E	F	G	L	R	S			
G6204S	G6404S	4	2T	3 <sup>3</sup> / <sub>4</sub>	1 <sup>1</sup> / <sub>2</sub> T	1 <sup>1</sup> / <sub>4</sub>	37 <sup>1</sup> / <sub>16</sub>	6 <sup>5</sup> / <sub>8</sub>	11	5	18 <sup>1</sup> / <sub>2</sub>	47 <sup>7</sup> / <sub>8</sub>	47 <sup>7</sup> / <sub>8</sub>	25	1 <sup>1</sup> / <sub>2</sub> T	1T	9.1	120	
G6206S	G6406S	4	2T	3 <sup>3</sup> / <sub>4</sub>	1 <sup>1</sup> / <sub>2</sub> T	1 <sup>1</sup> / <sub>4</sub>	37 <sup>1</sup> / <sub>16</sub>	6 <sup>5</sup> / <sub>8</sub>	11	5	30 <sup>1</sup> / <sub>2</sub>	47 <sup>7</sup> / <sub>8</sub>	47 <sup>7</sup> / <sub>8</sub>	37	2T	1T	13.8	148	
G6208S	G6408S	4	2T	3 <sup>3</sup> / <sub>4</sub>	1 <sup>1</sup> / <sub>2</sub> T	1 <sup>1</sup> / <sub>4</sub>	37 <sup>1</sup> / <sub>16</sub>	6 <sup>5</sup> / <sub>8</sub>	11	5	42 <sup>1</sup> / <sub>2</sub>	47 <sup>7</sup> / <sub>8</sub>	5 <sup>3</sup> / <sub>4</sub>	49	2 <sup>1</sup> / <sub>2</sub> T	1T	18.5	182	
G6210S	G6410S	4	2T	3 <sup>3</sup> / <sub>4</sub>	1 <sup>1</sup> / <sub>2</sub> T	1 <sup>1</sup> / <sub>4</sub>	37 <sup>1</sup> / <sub>16</sub>	6 <sup>5</sup> / <sub>8</sub>	11	5	54 <sup>1</sup> / <sub>2</sub>	47 <sup>7</sup> / <sub>8</sub>	5 <sup>3</sup> / <sub>4</sub>	61	2 <sup>1</sup> / <sub>2</sub> T	1T	23.2	207	
G6212S	G6412S	4	2T	3 <sup>3</sup> / <sub>4</sub>	1 <sup>1</sup> / <sub>2</sub> T	1 <sup>1</sup> / <sub>4</sub>	37 <sup>1</sup> / <sub>16</sub>	6 <sup>5</sup> / <sub>8</sub>	11	5	66 <sup>1</sup> / <sub>2</sub>	47 <sup>7</sup> / <sub>8</sub>	59 <sup>1</sup> / <sub>16</sub>	73	3T	1T	27.9	235	
G6214S	G6414S	4	2T	3 <sup>3</sup> / <sub>4</sub>	1 <sup>1</sup> / <sub>2</sub> T	1 <sup>1</sup> / <sub>4</sub>	37 <sup>1</sup> / <sub>16</sub>	6 <sup>5</sup> / <sub>8</sub>	11	5	78 <sup>1</sup> / <sub>2</sub>	47 <sup>7</sup> / <sub>8</sub>	59 <sup>1</sup> / <sub>16</sub>	85	3T	1T	32.6	262	
G6216S	G6416S	4	2T	3 <sup>3</sup> / <sub>4</sub>	1 <sup>1</sup> / <sub>2</sub> T	1 <sup>1</sup> / <sub>4</sub>	37 <sup>1</sup> / <sub>16</sub>	6 <sup>5</sup> / <sub>8</sub>	11	5	90 <sup>1</sup> / <sub>2</sub>	47 <sup>7</sup> / <sub>8</sub>	59 <sup>1</sup> / <sub>16</sub>	97	3T	1T	37.3	290	
G6218S	G6418S	4	2T	3 <sup>3</sup> / <sub>4</sub>	1 <sup>1</sup> / <sub>2</sub> T	1 <sup>1</sup> / <sub>4</sub>	37 <sup>1</sup> / <sub>16</sub>	6 <sup>5</sup> / <sub>8</sub>	11	5	102 <sup>1</sup> / <sub>2</sub>	47 <sup>7</sup> / <sub>8</sub>	59 <sup>1</sup> / <sub>16</sub>	109	3T	1T	42.1	318	
G6220S	G6420S	4	2T	3 <sup>3</sup> / <sub>4</sub>	1 <sup>1</sup> / <sub>2</sub> T	1 <sup>1</sup> / <sub>4</sub>	37 <sup>1</sup> / <sub>16</sub>	6 <sup>5</sup> / <sub>8</sub>	11	5	114 <sup>1</sup> / <sub>2</sub>	47 <sup>7</sup> / <sub>8</sub>	59 <sup>1</sup> / <sub>16</sub>	121	3T	1T	46.8	346	

SADDLE DIMENSIONS: H-6<sup>5</sup>/<sub>16</sub>; W-9<sup>1</sup>/<sub>4</sub>; X-7<sup>1</sup>/<sub>2</sub>; Hole Dia.-<sup>5</sup>/<sub>8</sub>

MATERIALS OF CONSTRUCTION (Unless otherwise indicated, standard will be furnished.)

	Standard	Optional
Shell	Steel	304ss, 316ss
Head	Cast Iron 4-10"	Fabricated Steel, Cast Bronze, Fabricated 304ss/316ss
	Fabricated Steel 12-30"	Cast Bronze, Fabricated 304ss/316ss
Tubes	3/4 x 20 BWG Copper	3/4 x 18 BWG Copper, Steel, 304ss, 316ss, 90/10 Cu Ni, Admiralty
Tube Sheet	Steel	Bronze, Brass, 304ss, 316ss, 90/10 Cu Ni
Separators	Steel	Bronze, Brass, 304ss, 316ss, 90/10 Cu Ni
Working Pressure	150 PSIG (ASME)	Consult Factory
Max. Temperature	375°F	Consult Factory

All dimensions shown are subject to change and should not be used for pre-piping. Contact your local Taco representative should certified dimensional drawings be required.

### Do it Once. Do it Right.

Taco, Inc., 1160 Cranston Street, Cranston, RI 02920 Telephone: (401) 942-8000 Fax: (401) 942-2360  
 Taco (Canada), Ltd., 6180 Ordan Drive, Mississauga, Ontario L5T 2B3 Telephone: (905) 564-9422 Fax: (905) 564-9436

Visit our website at: [www.taco-hvac.com](http://www.taco-hvac.com)

Printed in USA  
 Copyright 2007  
 TACO, Inc.