



Submittal Data Information

101-082

Model 003-IFC Cartridge Circulator

Effective: March 29, 2017

Supersedes: April 4, 2013

Job: _____ Engineer: _____ Contractor: _____ Rep: _____

| ITEM NO. | MODEL NO. | |
|----------|-----------|--|
| | | |

Features

- Integral Flow Check (IFC®) Patent #5,664,939
 - Prevents gravity flow / reverse flow
 - Eliminates separate in-line flow check
 - Reduces installed cost
 - Improves system performance
 - Easy to service
- Unique replaceable cartridge - Field serviceable
- Unmatched reliability-Maintenance free
- Quiet, efficient operation
- Self lubricating, No mechanical seal
- Wide range of applications
- Bronze 1/2", 3/4" sweat or Stainless Steel with union connections

Materials of Construction

Casing (Volute): Low-lead Bronze or Stainless Steel
 Integral Flow Check (IFC®):
 Body, Plunger.....Acetal
 O-ring Seals.....EPDM
 SpringStainless Steel
 Stator housing:.....Steel
 Cartridge:.....Stainless Steel
 Impeller:Non-metallic
 Shaft:.....Ceramic
 Bearings:.....Carbon
 O-Ring & Gaskets:.....EPDM - Chlorine resistant

Model Nomenclature

BC – Bronze, panel mount tappings
 SC – Stainless Steel, union connection, panel mount tappings
 IFC– Integral Flow Check

Performance Data

Flow Range: 0 - 6 GPM
 Head Range: 0 - 4.5 Feet
 Minimum Fluid Temperature: 40°F (4°C)
 Maximum Fluid Temperature: 220°F (104°C)
 Maximum Working Pressure: 125 psi
 Connection sizes: 1/2", 3/4" sweat or union

Certifications & Listings



Application

- Domestic Hot Water Recirculation
- Hydro-Air Fan Coils
- Heat Recovery Units
- Water Source Heat Pumps
- Potable Water Systems

The 003-IFC with an Integral Flow Check (IFC®) is designed for the circulation of hot or chilled fresh water in open or closed loop applications. The IFC feature simplifies piping, eliminates separate in-line flow check, reduces installation costs and improves system performance. With its patented location at the impeller inlet*, the IFC is easy to service without removing the entire unit from system piping. The unique, replaceable cartridge contains all of the moving parts and allows for easy service instead of replacing the entire circulator.

* IFC is located in the discharge port on union connection model only

Pump Dimensions & Weights

| Models | Conn. | A | | B | | C | | D | | E | | F | | Ship Wt. | |
|---------------|-----------|-----|-----|-------|-----|--------|----|---------|----|--------|----|---------|-----|----------|-----|
| | | in. | mm | in. | mm | in. | mm | in. | mm | in. | mm | in. | mm | lbs. | Kg |
| 003-BC4-1 IFC | 1/2" Swt. | 6 | 152 | 4-7/8 | 124 | 2-3/16 | 56 | 2-15/16 | 75 | 3-5/16 | 84 | 4-3/8 | 111 | 6.0 | 2.7 |
| 003-BC4-IFC | 3/4" Swt. | 6 | 152 | 4-7/8 | 124 | 2-3/16 | 56 | 2-15/16 | 75 | 3-5/16 | 84 | 4-3/8 | 111 | 6.0 | 2.7 |
| 003-SC4-IFC | Union | 6 | 152 | 4-7/8 | 124 | 2-3/16 | 56 | 2-15/16 | 75 | 3-5/16 | 84 | 5-15/16 | 151 | 6.0 | 2.7 |

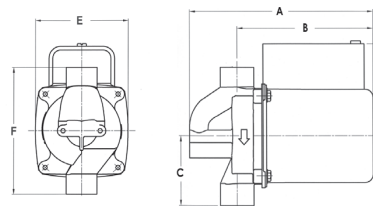

Mounting Positions

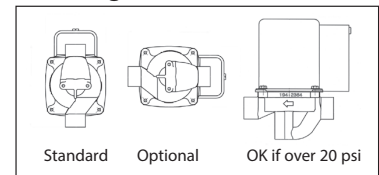

Electrical Data

| Model | Volts | Hz | Ph | Amps | RPM | HP |
|----------------|--|----|----|------|------|------|
| All 003 Models | 115 | 60 | 1 | .45 | 3250 | 1/40 |
| Motor Type | Permanent Split Capacitor Impedance Protected | | | | | |
| Motor Options | 220/50/1, 220/60/1, 230/60/1, 100/110/50/60/1 | | | | | |

Performance Field - 60Hz TACO INTEGRAL FLOWCHECK (IFC) MODELS

