

# DIMENSIONS & DATA CERTIFIED FOR:

Representative:

Order:

Customer:

Order:

Project:

Requirements:

By:

Date:

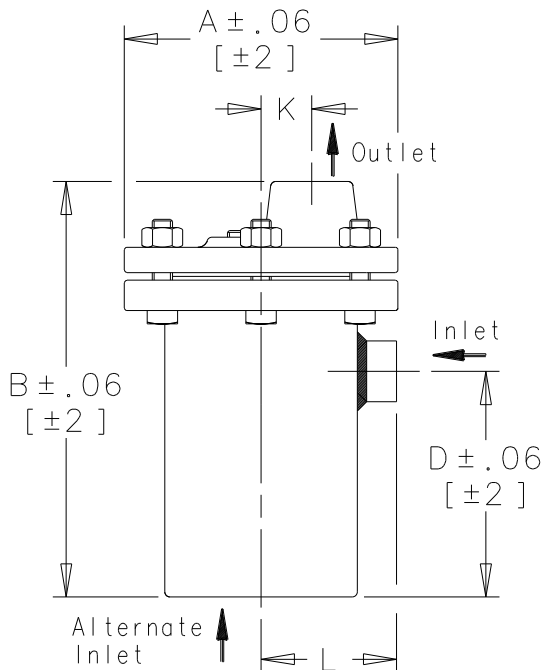
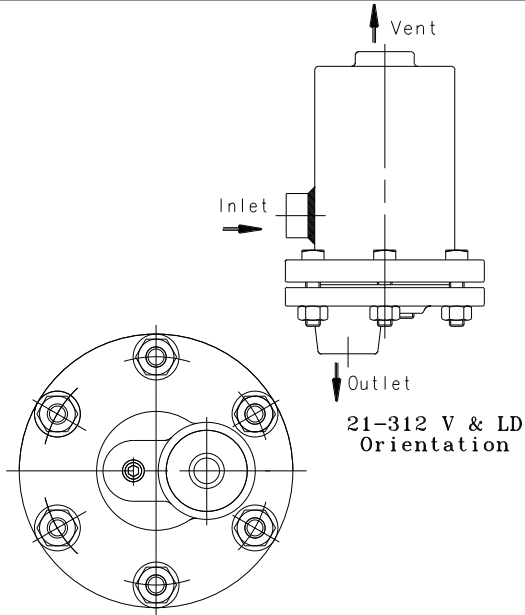

**21-312 AR & VAR**

## LIST OF MATERIALS:

NAME OF PART	MATERIAL
CAP & BODY	ASTM A105 (FORGED STEEL)
VALVE SEAT	HARDENED STAINLESS STEEL
VALVE	
LEVER ASS'Y	STAINLESS STEEL
FLOAT	
GASKET	GRAPHITE FOIL

## TECHNICAL INFORMATION

MODEL NO.	21-312 AR/VAR 21-312 V & LD			
PIPE CONNECTIONS	THD. SW	1/2 [DN15]	3/4 [DN20]	1" [DN25]
"A" (FLG. DIAMETER)	6-3/4 [171]			
"B" (HEIGHT)	10-1/4 [260]			
"D" (BOTTOM TO $\phi$ INLET)	5-9/16 [141]			
"K" ( $\phi$ OF TRAP TO $\phi$ OUTLET)	1-1/4 [32]			
"L" ( $\phi$ OF TRAP TO INLET)	3-9/32[83]	3-11/32[85]	3-21/32[93]	
WEIGHT	30 lbs [14 kgs]			

## DESIGN INFORMATION

MAXIMUM ALLOWABLE PRESSURE (VESSEL DESIGN)	600 psig at 100°F [41 bar at 38°C]
	500 psig at 750°F [34 bar at 399°C]



Product

ENGLISH

CD No.

Date

21-312 AR/VAR  
21-312 V & LD

WEB  
Y | N  
✓

1106

7/5/07

Rev; B

By; Paul G.