



| | |
|-------------|---------------|
| FILE NO: | 113.59 |
| DATE: | Nov. 03, 2011 |
| SUPERSEDES: | New |
| DATE: | New |

Brazed Plate Heat Exchanger

Model ABD100 - Double Wall

SUBMITTAL

| | |
|-------------------|---------------------------------|
| JOB: _____ | REPRESENTATIVE: _____ |
| ENGINEER: _____ | ORDER NO: _____ DATE: _____ |
| CONTRACTOR: _____ | SUBMITTED BY: _____ DATE: _____ |
| | APPROVED BY: _____ DATE: _____ |

| QUANTITY | TAG No. | MODEL No. | COMMENTS |
|----------|---------|-----------|----------|
| | | | |

ABD - BRAZED PLATE HEAT EXCHANGERS DOUBLE WALL

Armstrong's ABD brazed plate heat exchangers are designed to facilitate heat transfer between two media of different temperatures. ABD produces high heat transfer rates that allow for a compact, corrosion resistant and robust design.

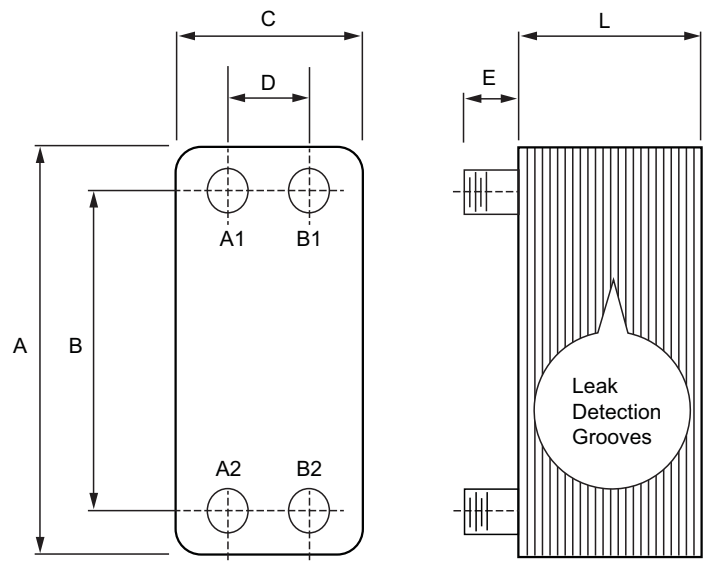

TYPICAL SPECIFICATION

Furnish and install on the plans and described herein, an Armstrong ABD100-_____ brazed plate heat exchanger. Each heat exchanger must be designed to have the capacity and pressure/temperature rating as detailed in the schedule. The heat exchanger must utilize 316L stainless steel plates and copper braze to separate the two fluids while transferring heat and preventing corrosion.

To prevent cross contamination of the two media the heat exchanger shall be of double wall design. **The media shall be separated by two plates with an air gap between them providing a positive leak path with detection grooves.**

Each heat exchanger shall be Armstrong ABD100-_____ or approved equal.

CONSTRUCTION

| Connections | | | | Description | Dimensions - inch (mm) | |
|--|-------------|----------|--------|---|------------------------|---|
| | Size - inch | Location | Rating | Number of plates (N): | A | 20.80 (529) |
| Fluid 1 Inlet | 1.00 | A2 | NPT | Design Pressure <input type="checkbox"/> 435 psi (30 bar) <input type="checkbox"/> 150 psi (10 bar)* | B | 18.80 (478) |
| Fluid 1 Outlet | 1.00 | A1 | NPT | | C | 4.90 (124) |
| Fluid 2 Inlet | 1.00 | B1 | NPT | Max Temperature 437 °F/150 °C | D | 2.90 (73) |
| Fluid 2 Outlet | 1.00 | B2 | NPT | Plate Material <input type="checkbox"/> 316 SS <input type="checkbox"/> NiMo SS** | E | 0.80 (20) |
| Notes | | | | | L | 0.51 + 0.095N (12.95 + 2.4N) |
| * Design pressure with N: Braze ** NiMo SS is a high alloy stainless steel for corrosion resistance | | | | Braze Material <input type="checkbox"/> Copper <input type="checkbox"/> Nickel* | Weight | 4.4 + (0.6 x N) lbs 2.0 + (0.25 x N) kgs |
| | | | | Connection Material <input type="checkbox"/> 304 SS <input type="checkbox"/> 316 SS | Volume | (0.02 x N) gals (0.09 x N) liters |

S. A. Armstrong Limited
23 Bertrand Avenue
Toronto, Ontario
Canada, M1L 2P3
T: 416-755-2291
F: 416-759-9101

Armstrong Pumps Inc.
93 East Avenue
North Tonawanda, New York
U.S.A. 14120-6594
T: 716-693-8813
F: 716-693-8970

Armstrong Integrated Limited
Wenlock Way
Manchester
United Kingdom, M12 5JL
T: +44 (0) 8444 145 145
F: +44 (0) 8444 145 146



© S.A. Armstrong Limited 2011

For Armstrong locations worldwide, please visit www.armstrongintegrated.com